

SITE PLAN

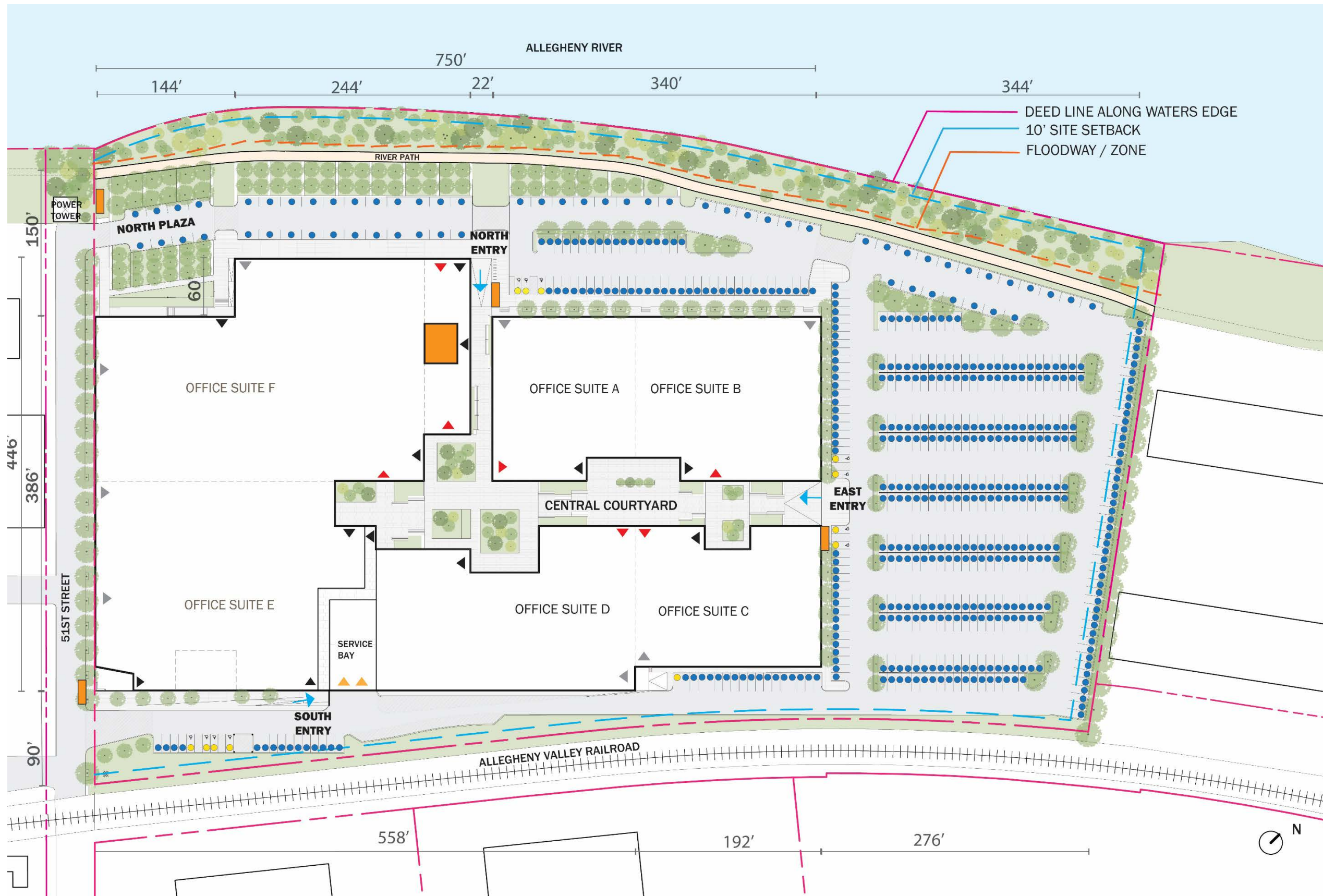

- 508 STANDARD PARKING SPOT
- 12 ACCESSIBLE PARKING SPOT
- 520** TOTAL PARKING SPOTS
- 150 BIKE PARKING
- ← SITE ENTRY POINTS
- ▲ MAIN ENTRANCES TO SUITES
- ▲ STAFF ENTRANCES TO SUITES
- ▲ OVERHEAD DOOR TO SUITES
- ▲ LOADING DOCK